



**Ground breaking  
Simulation Solutions**

*physics on screen*

---

# How Compare-function can become the secret ingredient for reducing model build-up effort

Michael Tryfonidis

## Contents

- Motivation
- Requirements
- Commonalities
- Compare aids decision making
- Outcome
- Further uses

# Motivation: Model Preparation process

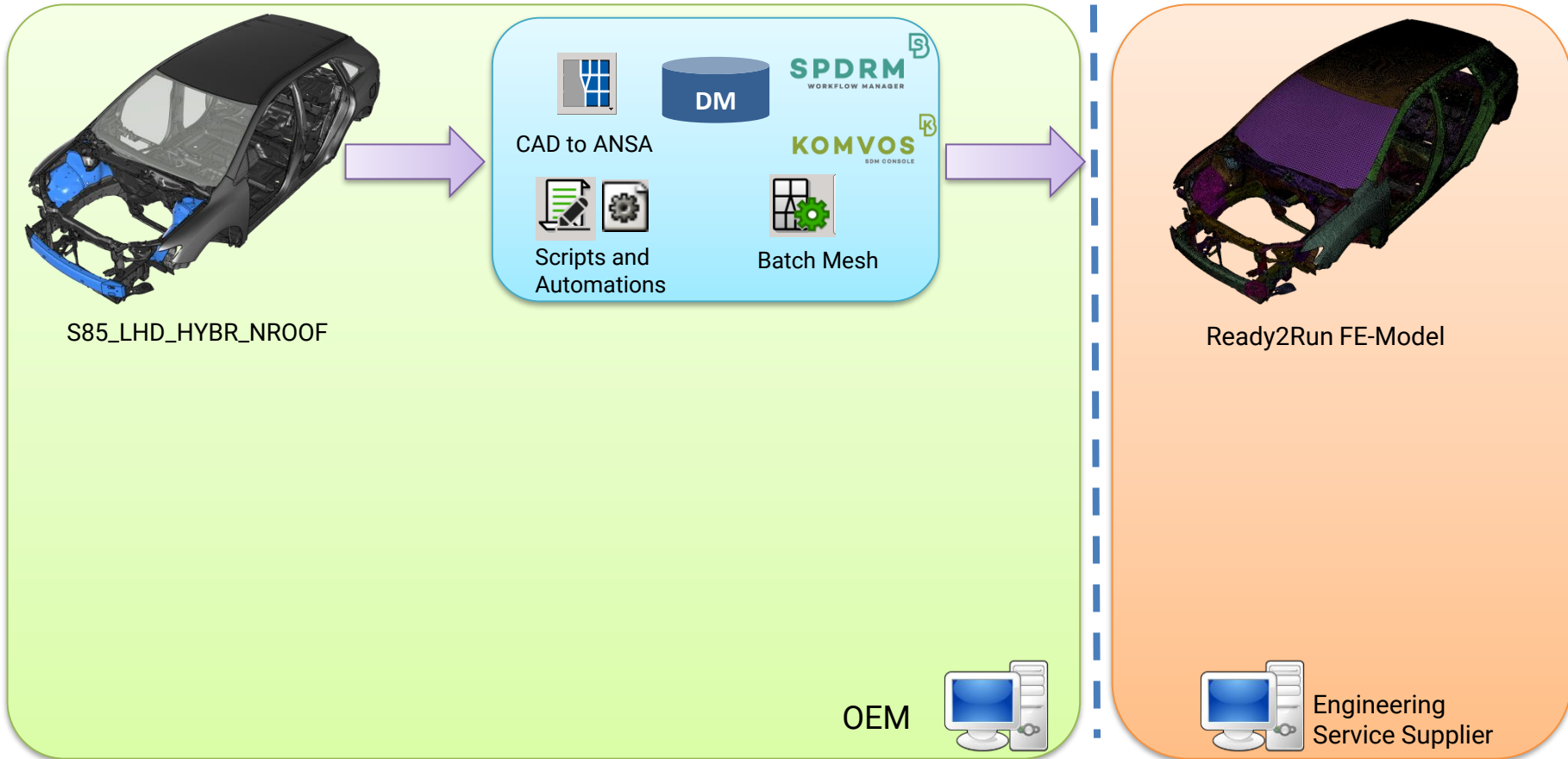

# Motivation: Model Preparation process

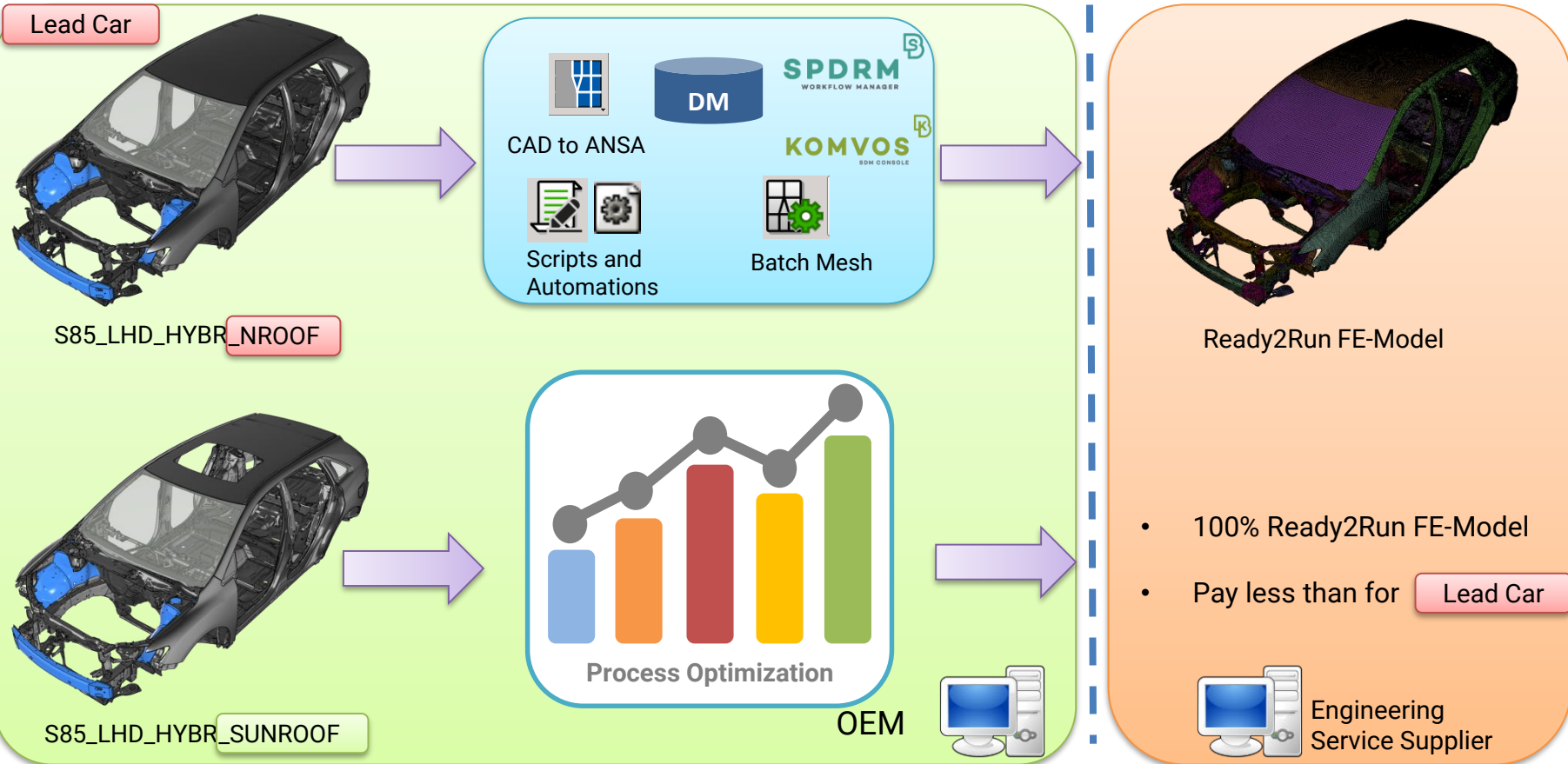

# Motivation: Model Preparation process

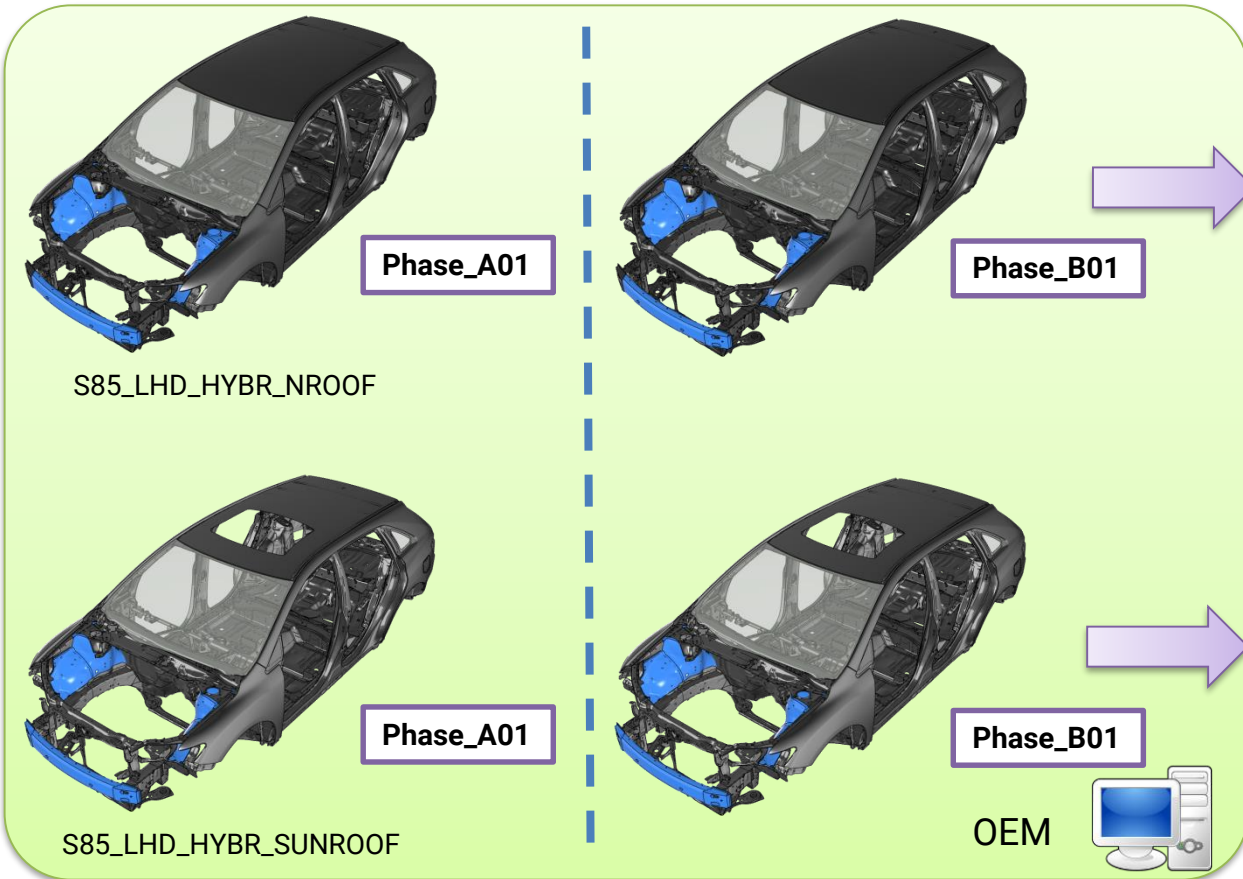

- 100% Ready2Run FE-Model
- Pay less than for Phase\_A

- 100% Ready2Run FE-Model
- Pay less than for Phase\_A



Engineering  
Service Supplier

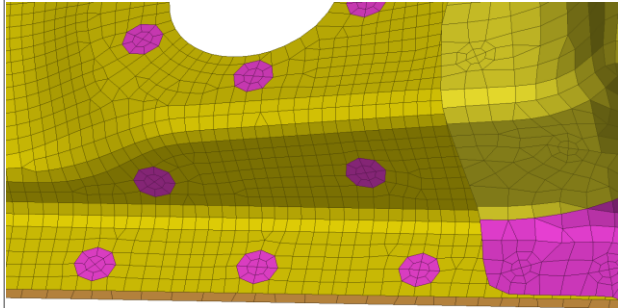

Special meshing for welding

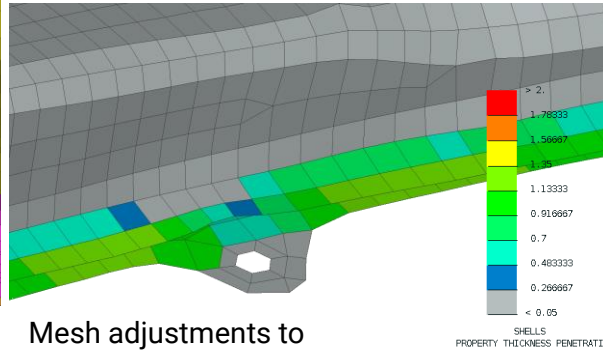

Mesh adjustments to solve penetration cases

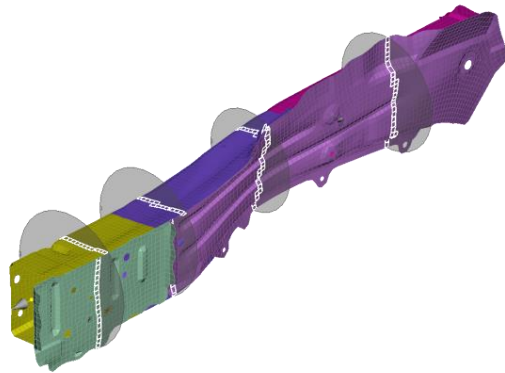

Boundary Conditions and Output Requests

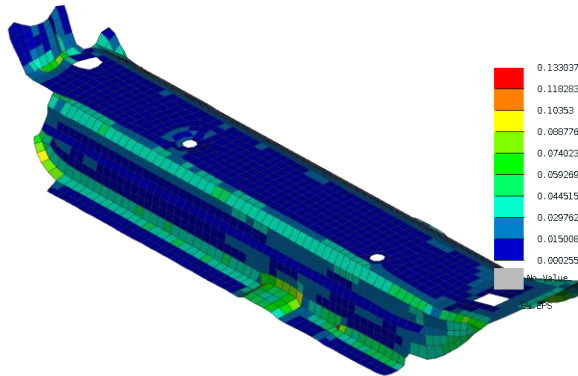

Several additions such as forming simulation data, composite data etc.

## Model Preparation Process

Requirement is to inherit the most from the reference ready-2-run FE-include files

- Special meshing for welds
- Contacts, sets
- Output requests
- Any other special adjustment

Lead Car



S85\_LHD\_HYBR\_NROOF



S85\_LHD\_HYBR\_SUNROOF

S85\_LHD\_HYBR\_SUNROOF vs. Lead Car

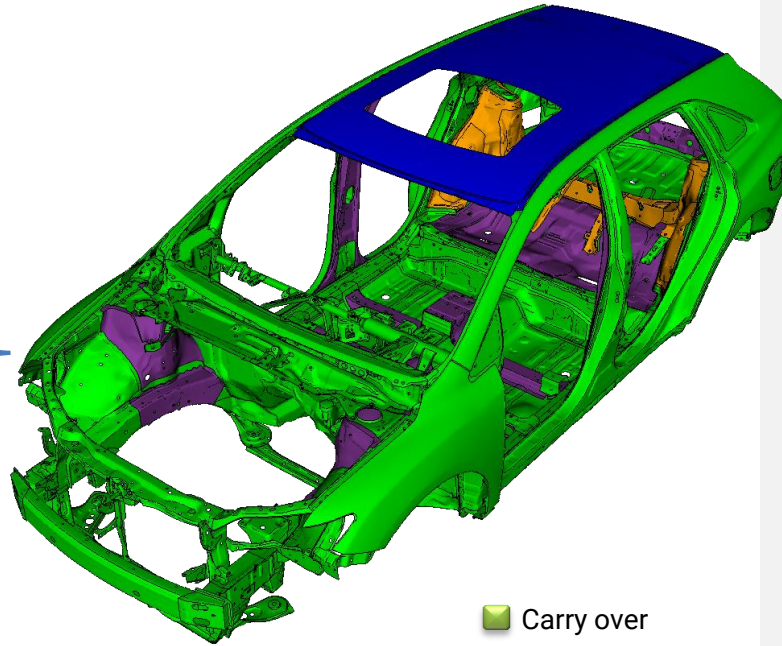

■ Carry over

■ New Parts

■ New Version

■ Moved

## Compare Commonalities

Calculate the commonality factor of a model by comparing it's structure to a reference model.

Requires CAD-Attribute:

- Part/Module Id's
- Version
- Transformation Matrix



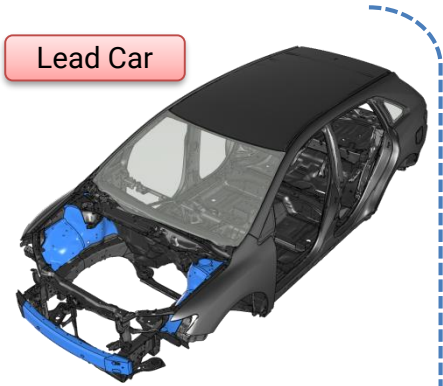

Lead Car

S85\_LHD\_HYBR\_NROOF



S85\_LHD\_HYBR\_SUNROOF

S85\_LHD\_HYBR\_SUNROOF vs. Lead Car

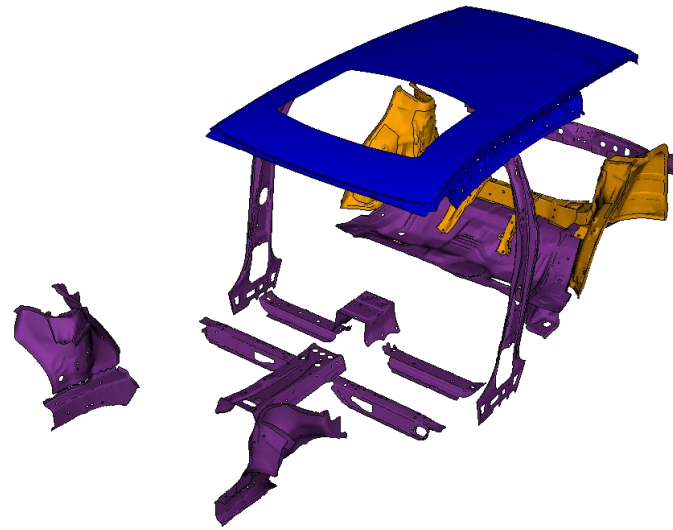

- Carry-over
- New Parts
- New Version
- Moved

## Compare Commonalities

Calculate the commonality factor of a model by comparing it's structure to a reference model.

Requires CAD-Attribute:

- Part/Module Id's
- Version
- Transformation Matrix

Lead Car

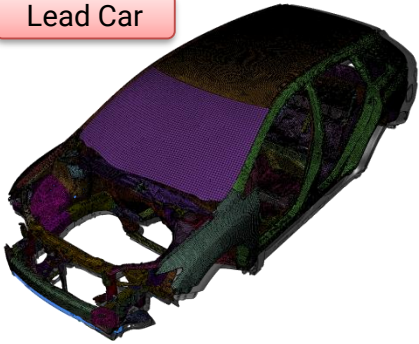

S85\_LHD\_HYBR\_NROOF  
Ready2Run FE-Model

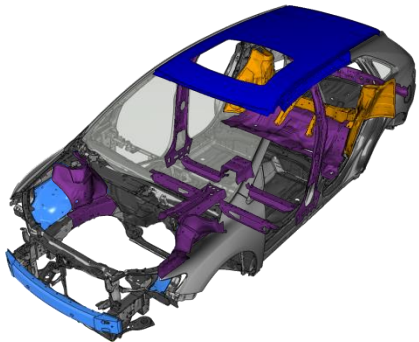

S85\_LHD\_HYBR\_SUNROOF

Ready2Run FE-Model means

- Might require the input of multiple files
- Cannot rely on the existence of hierarchic info
- No ANSA-comments
- Cannot rely on nomenclatures



**Compare Tool**

## Compare in Detail Requirements

Dealing with FE-Includes

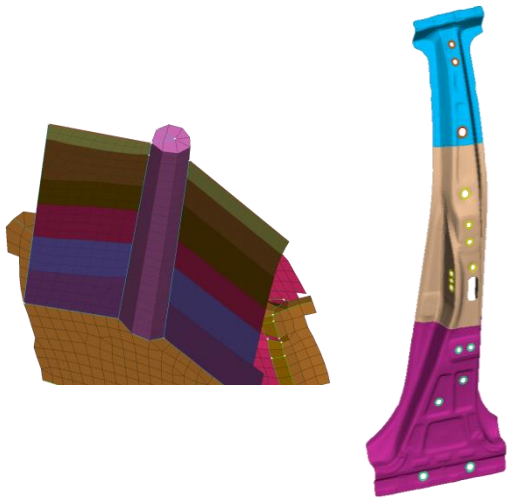

Parts may consist of multiple  
pids or FE-element types chosen

## Compare in Detail Requirements

### Dealing with FE-Includes

- Group FE-entities into parts to enable comparison

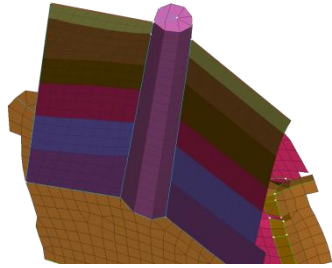

Parts may consist of multiple  
pids or FE-element types chosen

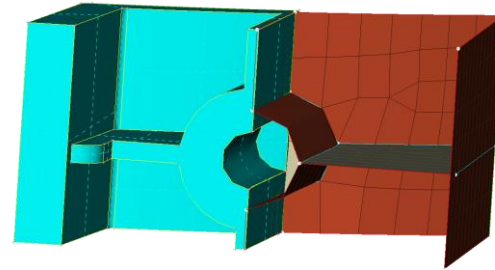

Recognize solid vs. mid-  
surface comparison cases

## Compare in Detail Requirements

### Dealing with FE-Includes

- Group FE-entities into parts to enable comparison
- Solid vs mid-surface description

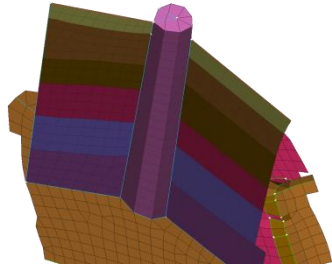

Parts may consist of multiple parts or FE-element types chosen

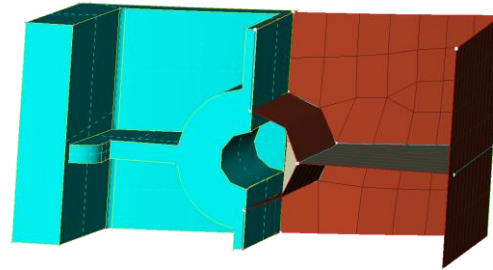

Recognize solid vs. mid-surface comparison cases

Compare Criteria

<input checked="" type="checkbox"/> GEO Accuracy >	2	% as Diffs	<input type="checkbox"/> Connections
<input checked="" type="checkbox"/> Thickness Accuracy >	5	%	<input type="checkbox"/> Ignore diffs if Version is same
<input type="checkbox"/> Mass Accuracy >	5	%	
<input type="checkbox"/> Advanced - User Defined			

Compare criteria to decide when a difference should actually be considered as such

## Compare in Detail Requirements

### Dealing with FE-Includes

- Group FE-entities into parts to enable comparison
- Solid vs mid-surface description
- Define the decisive criteria for difference computation

# Compare in Detail Requirements

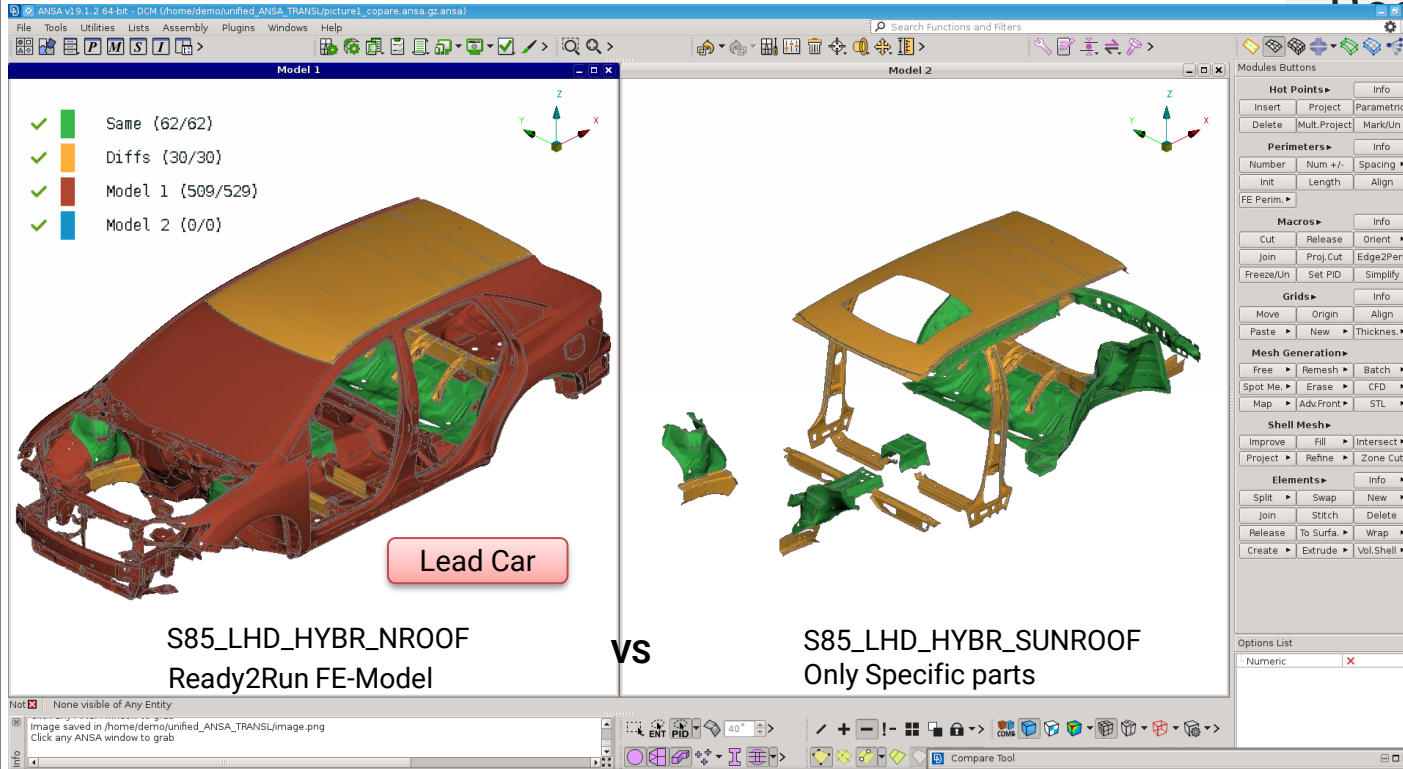

working with FE-Includes  
group FE-entities into  
parts to enable  
comparison  
solid vs mid-surface  
description  
refine the decisive  
criteria for difference  
computation  
overview of pairs  
with differences  
according to the  
compare Criteria

# Compare in Detail Decision making

- Examine each pair to explore differences

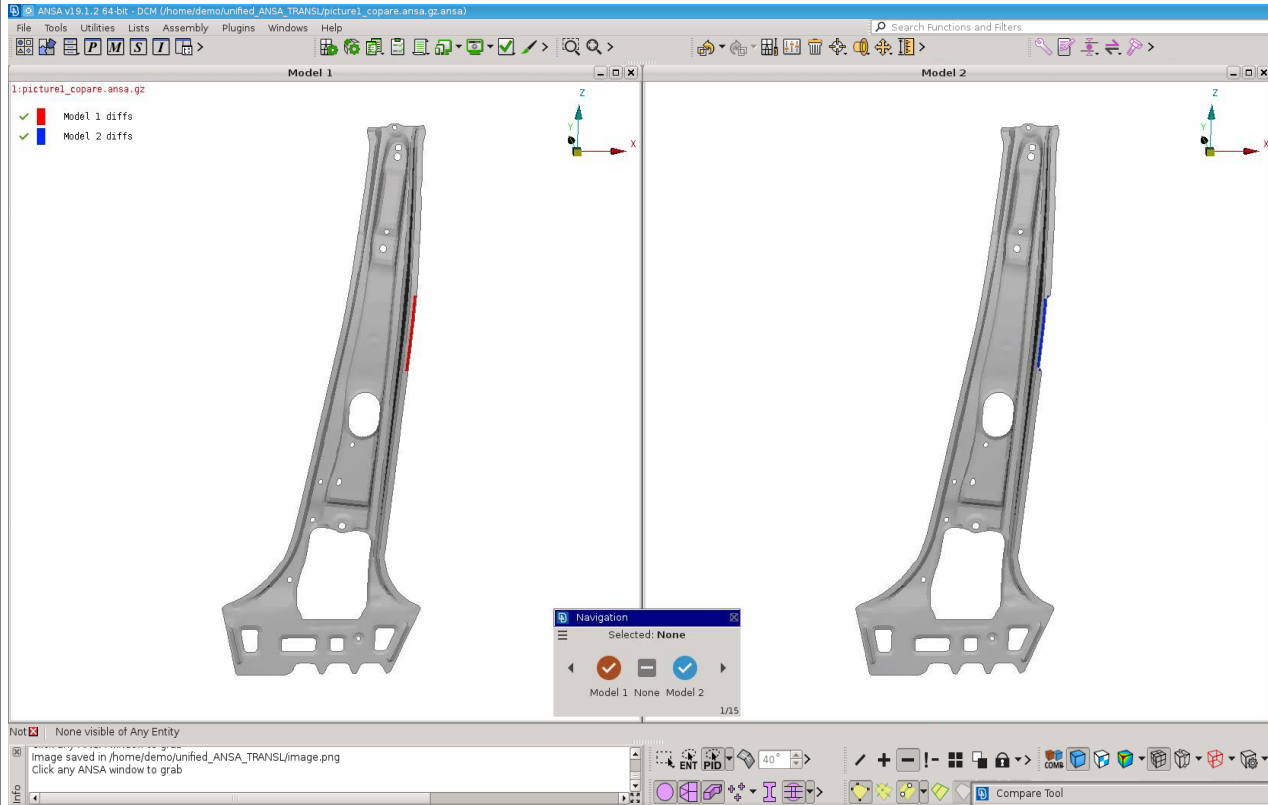

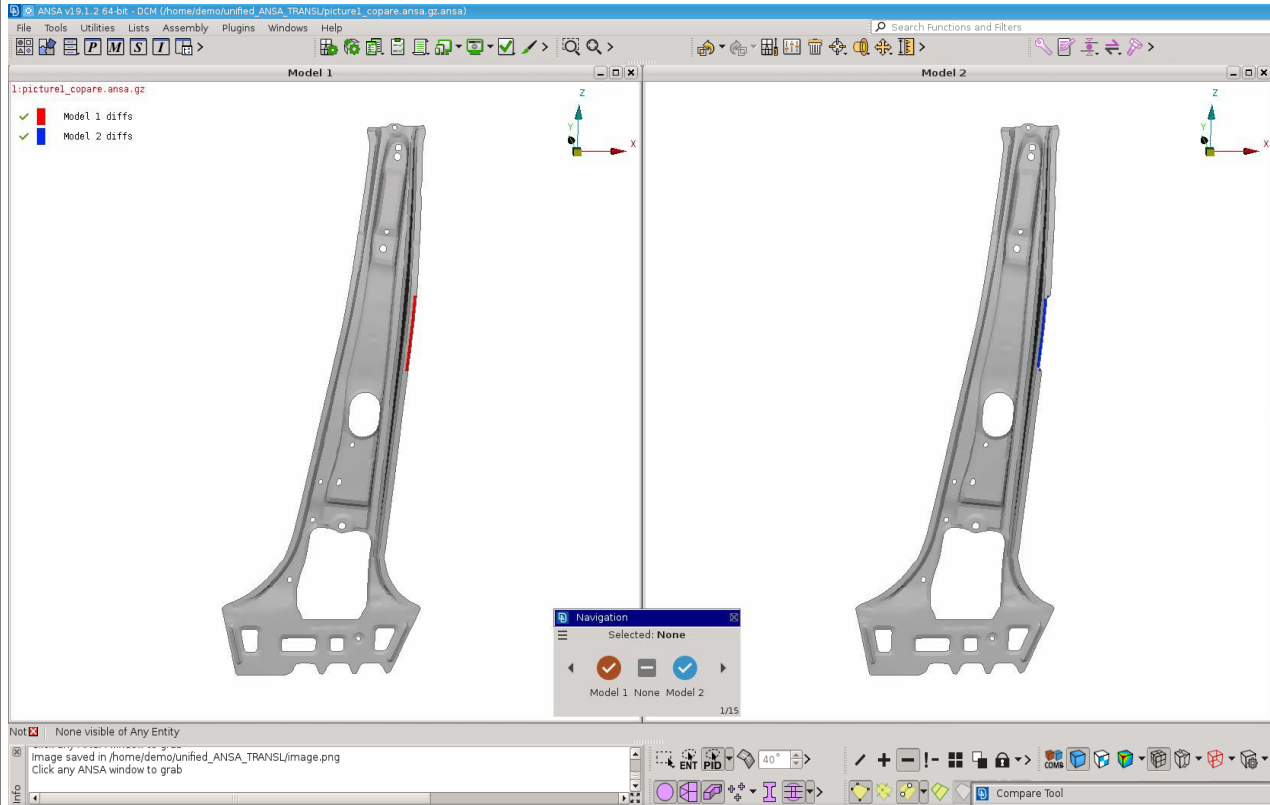

## Compare in Detail Decision making

- Examine each pair to explore differences
- For non decisive parts differences, parts can be marked as excluded



# Compare in Detail Decision making

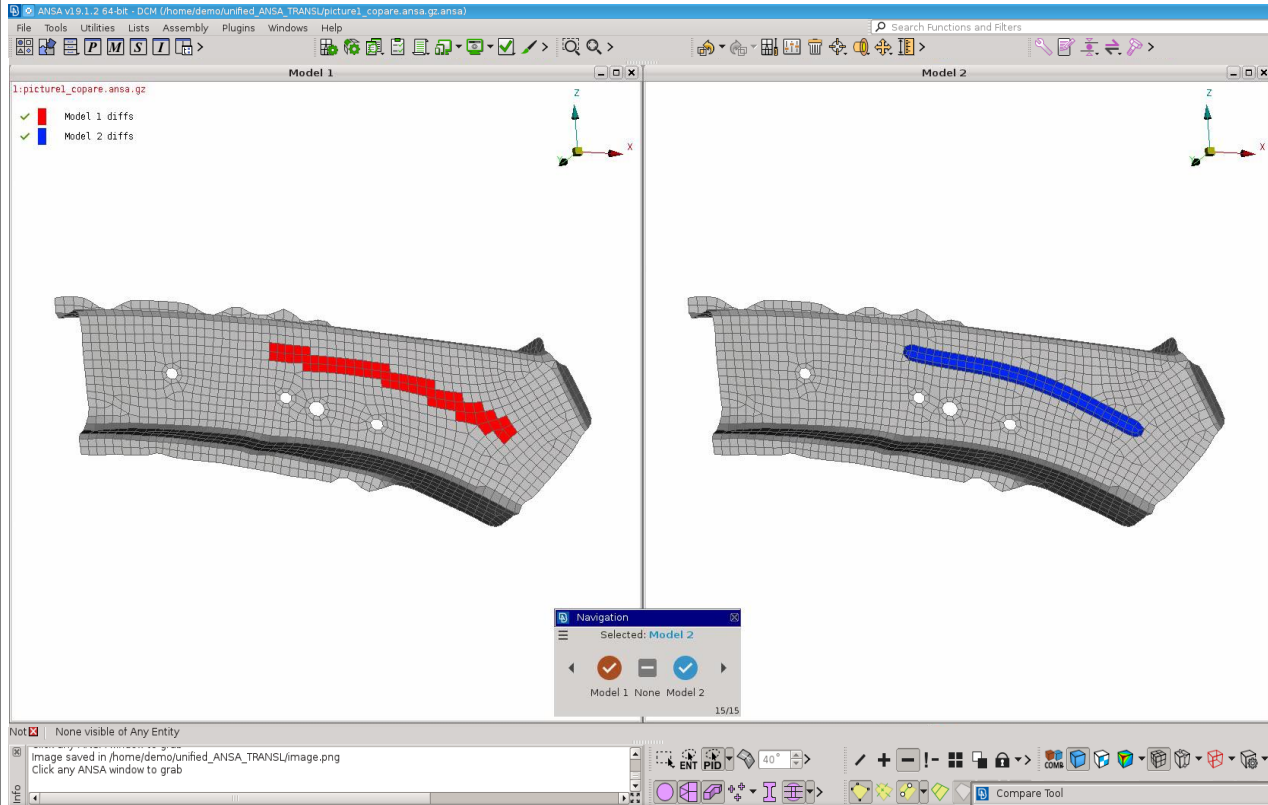

- Examine each pair to explore differences
- For non decisive parts differences, parts can be marked as excluded
- For decisive differences, parts are marked to be kept

# Compare in Detail Decision making

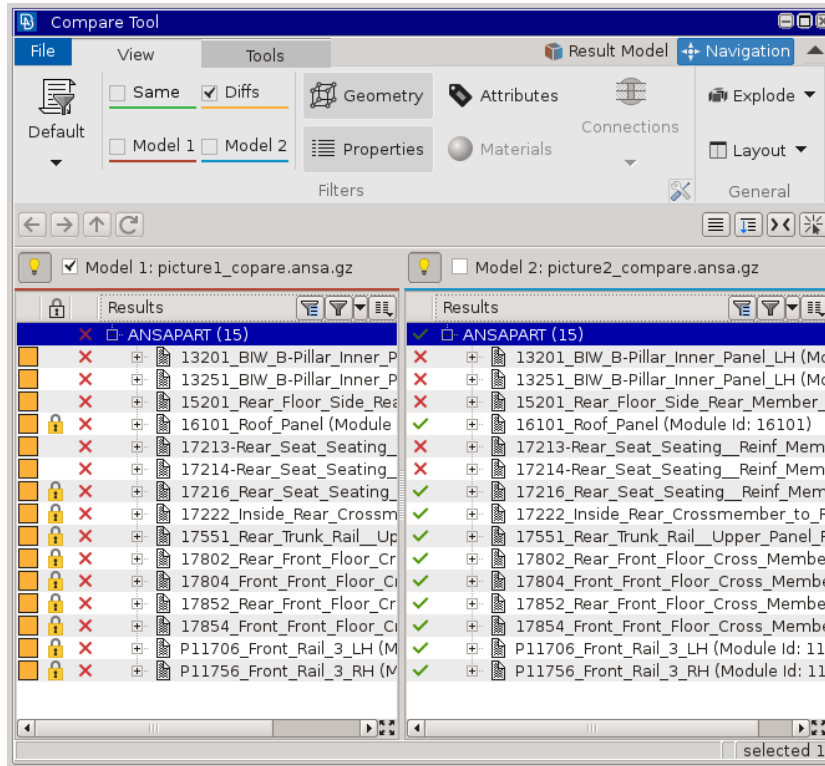

- Examine each pair to explore differences
- For non decisive parts differences, parts can be marked as excluded
- For decisive differences, parts are marked to be kept
- Produce Result Model

# Compare in Detail Decision making

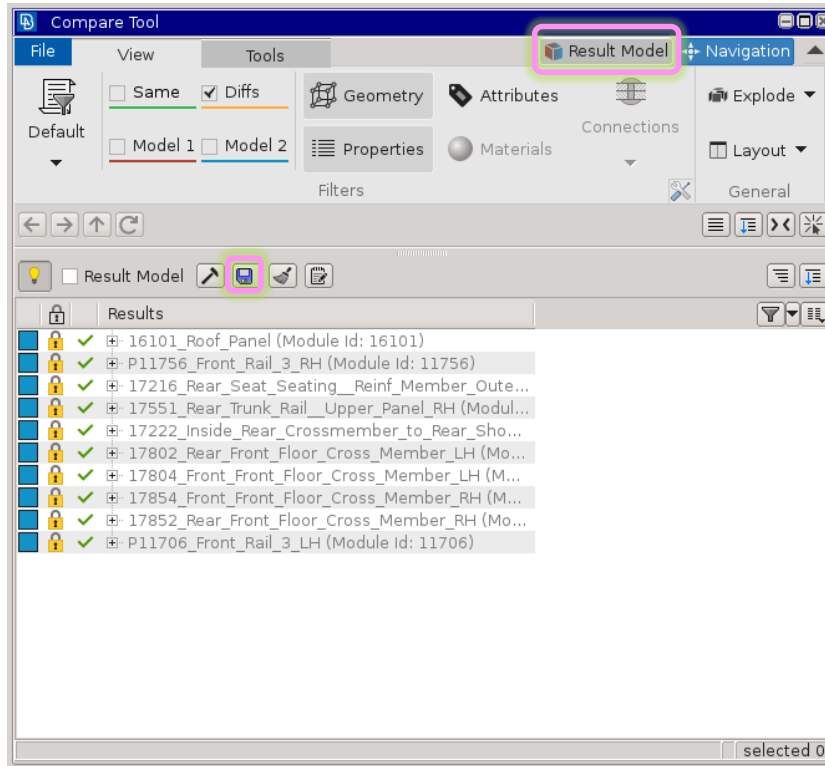

- Examine each pair to explore differences
- For non decisive parts differences, parts can be marked as excluded
- For decisive differences, parts are marked to be kept
- Produce Result Model

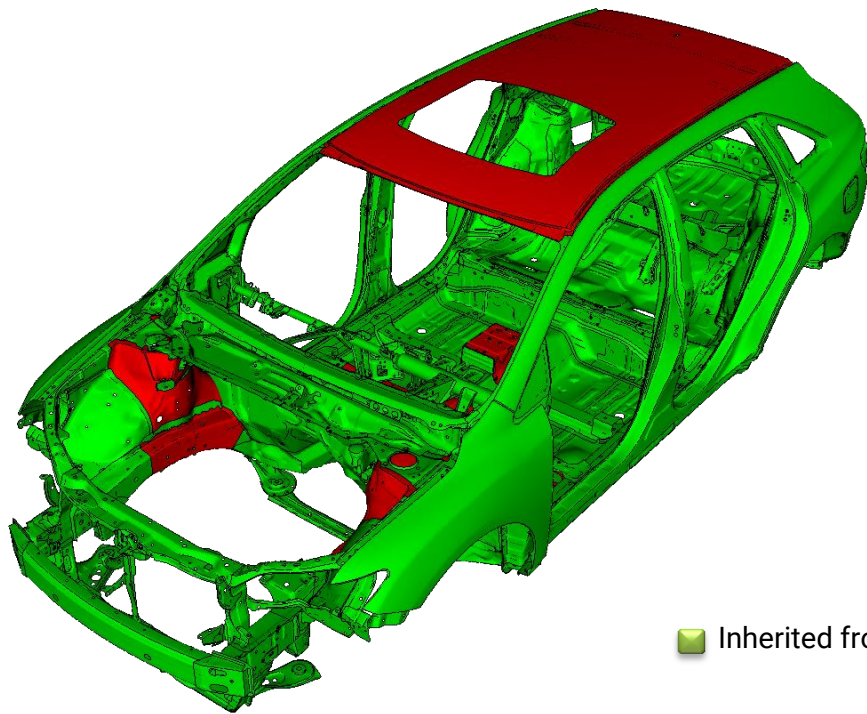

 Inherited from Lead Car

 New parts

## Compare in Detail Decision making

- Examine each pair to explore differences
- For non decisive parts differences, parts can be marked as excluded
- For decisive differences, parts are marked to be kept
- Produce Result Model

## Compare in Detail Decision making

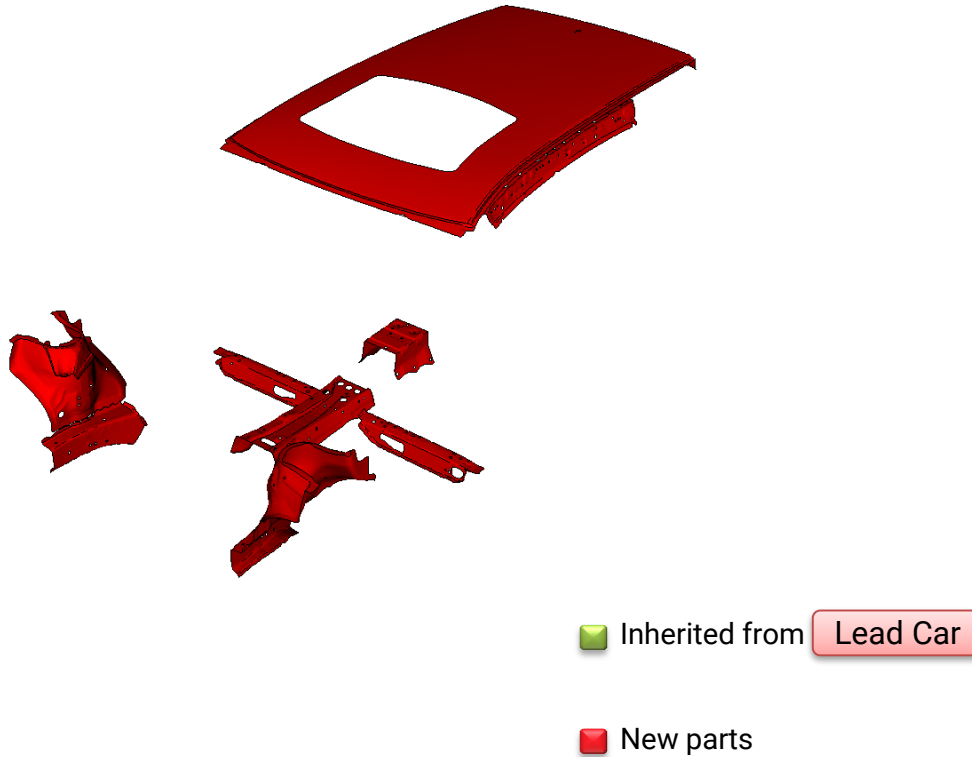

- Examine each pair to explore differences
- For non decisive parts differences, parts can be marked as excluded
- For decisive differences, parts are marked to be kept
- Produce Result Model

# Outcome

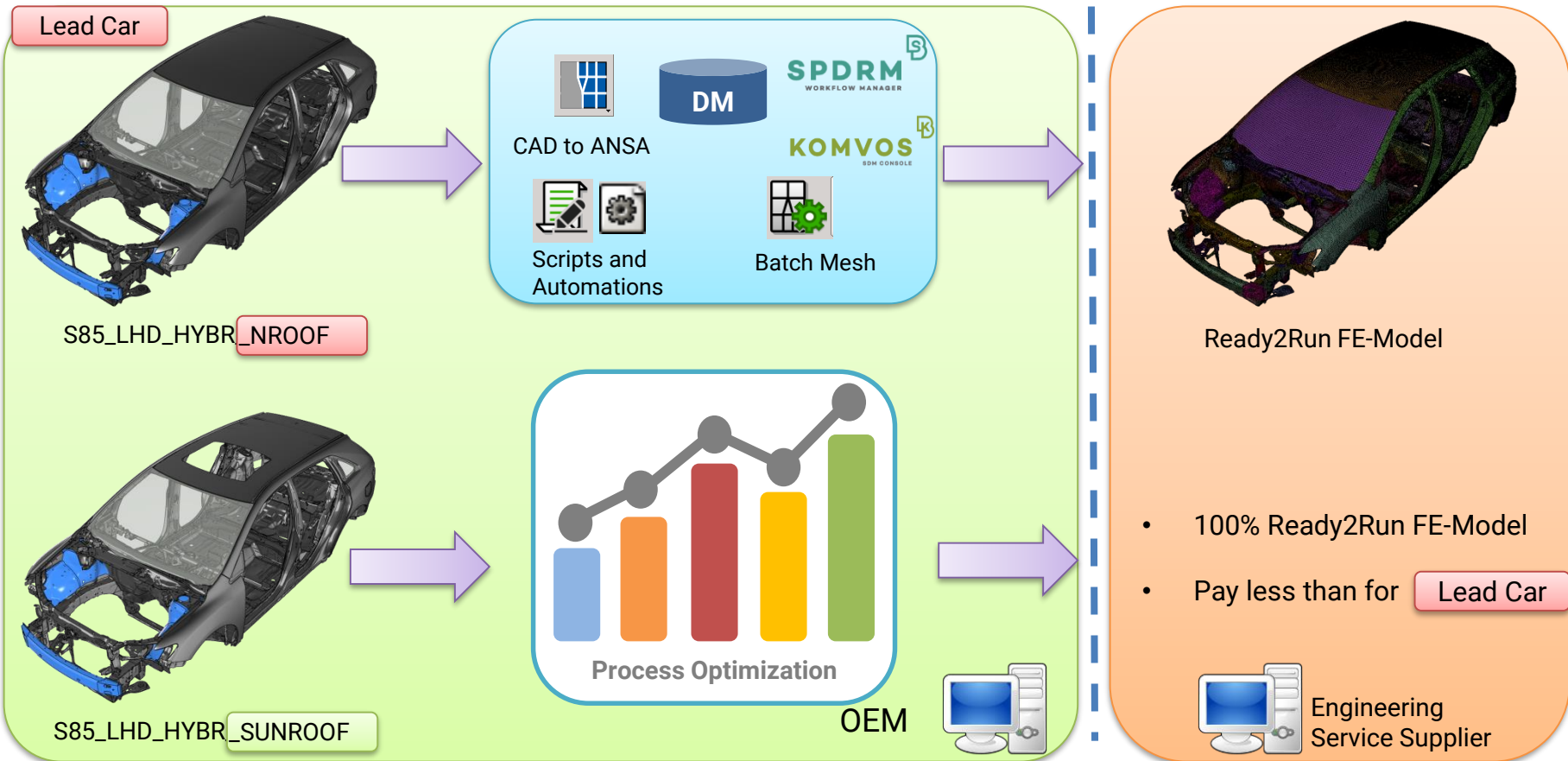

# Outcome

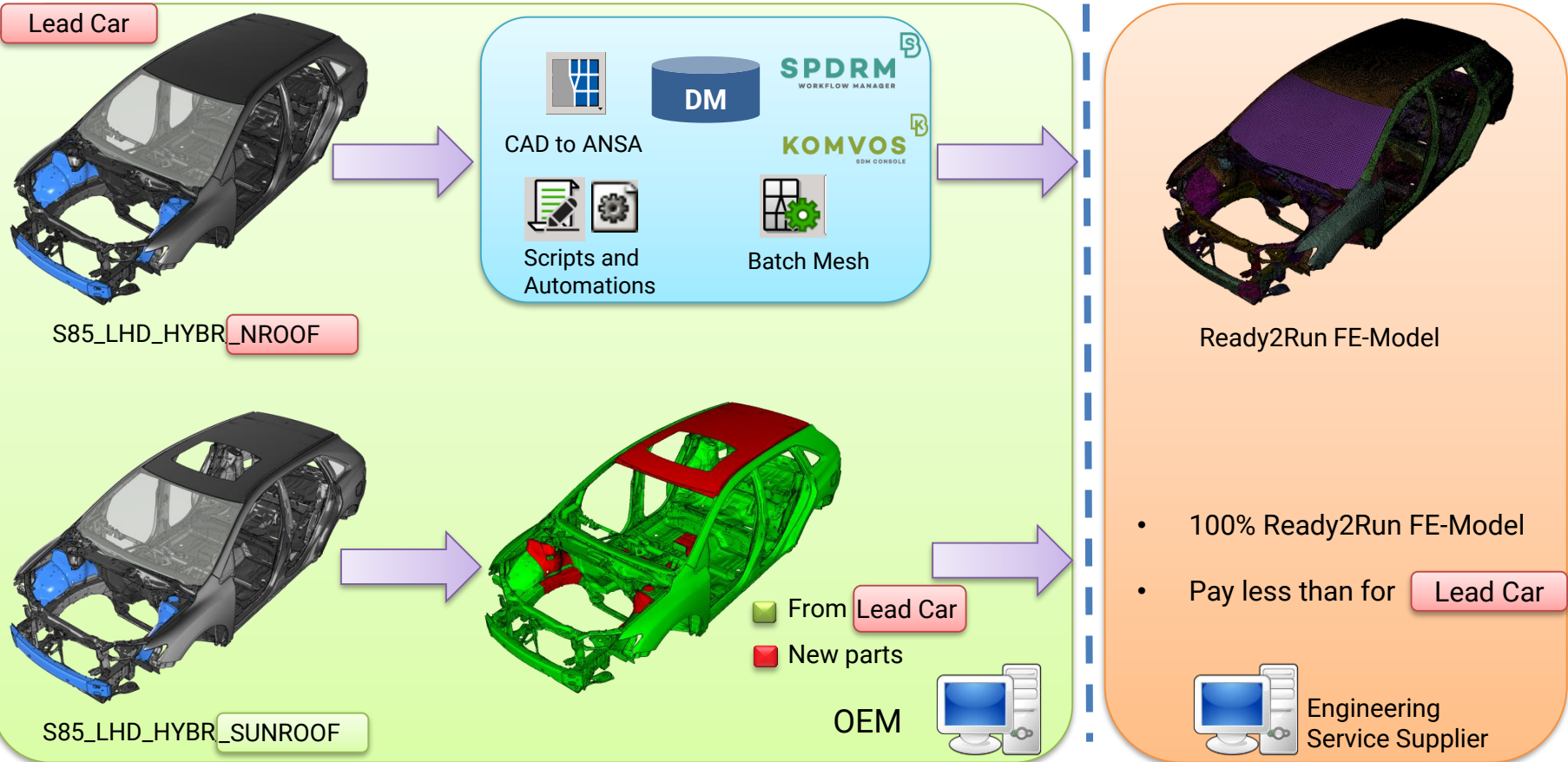

- Transfer individual properties/faces between models
- Mapping purposes: PID, Material names, Stamp mapping process
- Quality check and reporting
- Feedback Mesh representation in ANSA-DM
- Special compare for Composites, Stamp Data
- Compare CFD

Submodel Underbody  
CFD-Lead Mesh

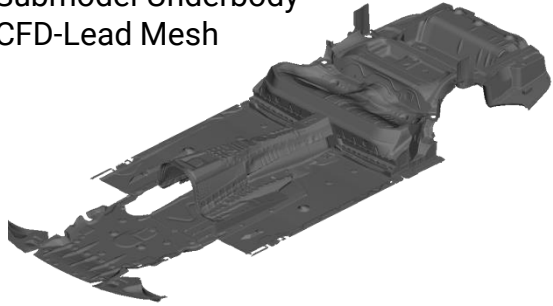

New Geometries

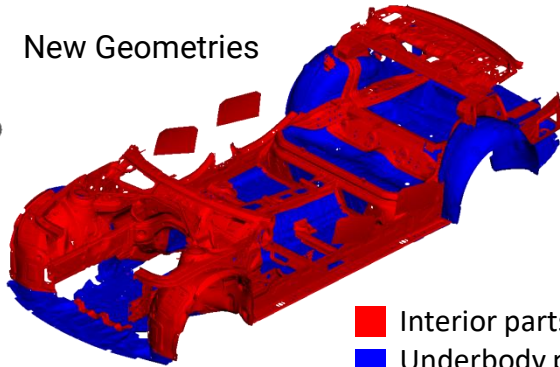

- Interior parts
- Underbody parts

Compare CFD-Scenario

## Compare Tool Other uses

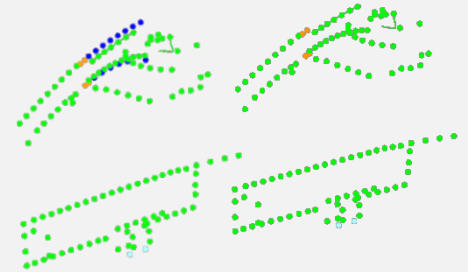

Welds Compare

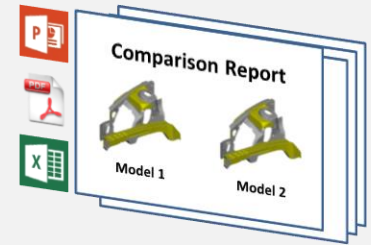

Compare Report



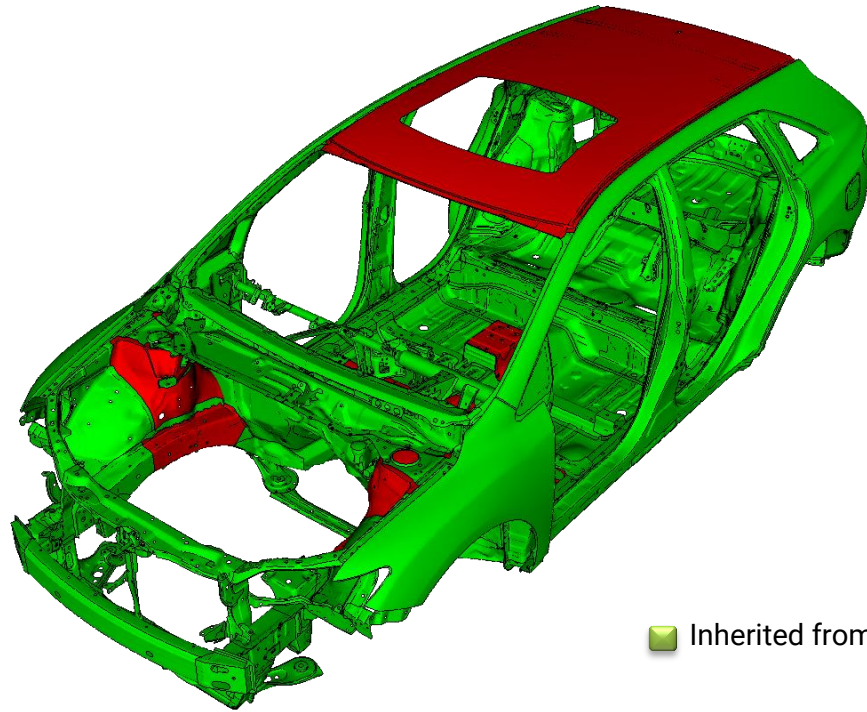

**Stay connected**

 Inherited from **Lead Car**

 New parts



**Stay connected**

Text size no smaller than 16

**Text Box**

Title

Description